

**TRACTO**

## Options presentation W-series



## Updates

- April 2024
  - Page 17 / Clarification, minor change
  - Page 18 / Clarification, minor change
  - Page 19 / Battery change removed on TWE200
- April 2025
  - Page 18 / New option "Hour counter" added



## Content

- Principle to connect a roller cage to TWE120
- Standard hook
- Adjustable mechanical locking hook
- Electrical locking hook
- Principle to connect a trailer to TWE200
- Standard towing device and tow ball
- Combination towing device/tow ball
- Coupling device waste bin
- Coupling device for shopping cart
- Remote Control
- Extra weight package
- Keypad
- Hour counter
- Battery table
- Battery set, AGM, 2 x 12V/22Ah
- Battery set, AGM, 2 x 12V/36Ah
- Battery set, GEL , 2 x 12V/76Ah
- Battery, Lithium, 1 x 24V/48Ah
- Battery, Lithium, 1 x 24V/96Ah
- Charger, 24V/4A (For AGM batteries)
- Charger, 24V/16,5A (For GEL batteries)
- Charger, 24V/40A (For Lithium batteries)
- Charger, 24V/80A (For Lithium batteries)

## ***TRACTO*** **Options for W-series**

is designed around 4 core values that customers can benefit



## Principle to connect a roller cage to TWE120



TWE120

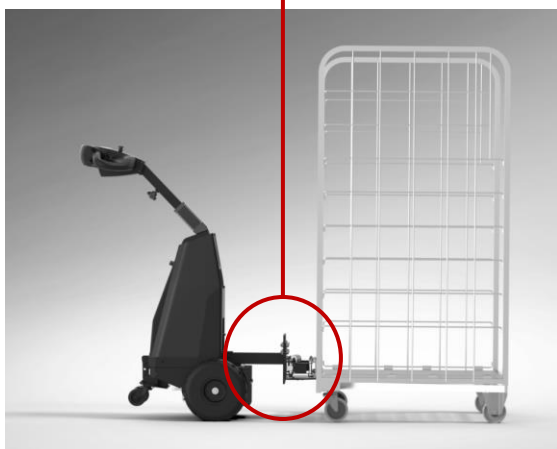
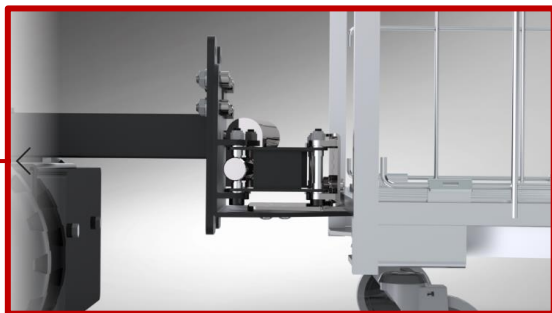

- Used mainly to handle roller cages and trolleys [TWE120]
- The roller cage is connected by different coupling devices. These couplings need to fit the dimension of the roller cage
- Standard hooks (1)
- Adjustable mechanical locking hook (2)
- Electrical locking hook (3)

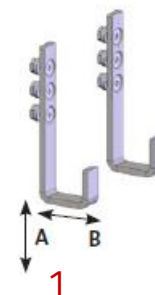

1

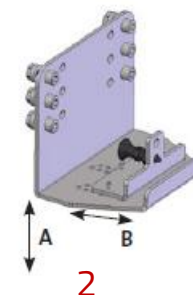

2

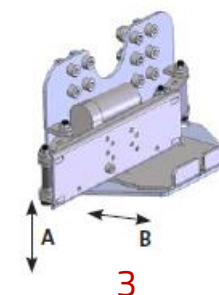

3

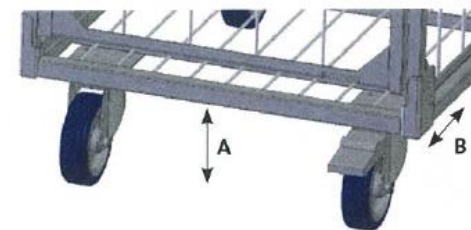

A Min/max height on trolley

B Profile width on trolley

- Measurements of A and B guides you in choice of coupling devices
- Special hooks also available on request

## Principle to connect a roller cage to TWE120

**[TWE120]****TWE120****Standard hooks**

- Standard solution
- Can be used on flat ground (no slopes)
- Can be suited to a wide range of trolley

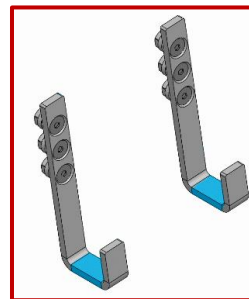
**Adjustable mechanical locking hook**

- Option that can be used when having uneven ground and slopes
- The trolley is locked/released by the switch by hand

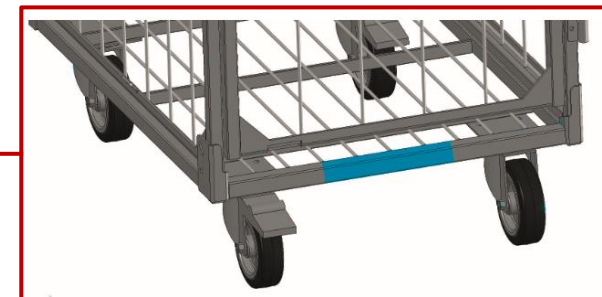
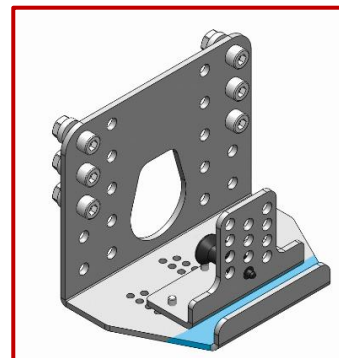
**Electrical locking hook**

- Option that can be used when having uneven ground and slopes
- The trolley is locked/released by button positioned on handle
- Fits a wide range of different trolleys
- Provides with good ergonomics in intensive applications

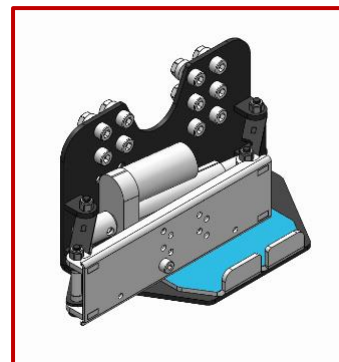

[TWE120]

## Standard hook [Included as standard in base model]

### Features

- Standard hook for model TWE120
- Come in pair
- Not intended for use in application with inclination

### Benefits

- Compatible with a wide variety of trolleys thanks to its different settings

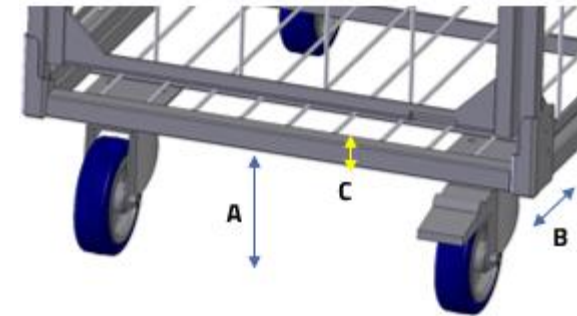
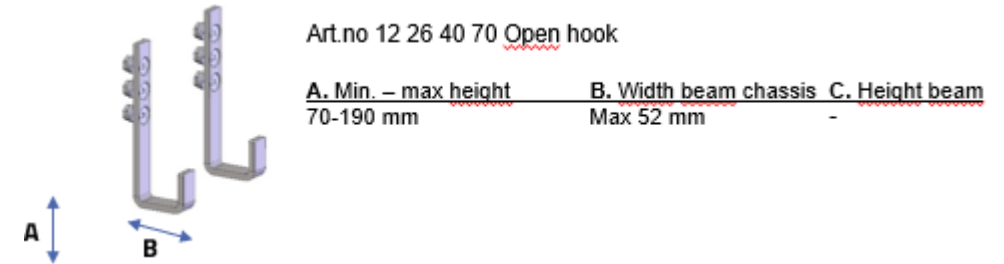

Possibility to choose the tow device that suits the customers application = the correct equipment for the application = increased productivity = decreased handling cost



[TWE120]

## Adjustable mechanical locking hook [12 26 41 00]

### Features

- This hook connect and locks the trolley to the tractor
- The locking pin is pulled backwards by hand and then pushed forward to lock the trolley
- Can be used in application with inclination

### Benefit

- This hook prevents the trolley from detaching from the tow device, which is particularly important on a slope
- Compatible with a wide variety of roll trolleys

Possibility to choose the tow device that suits the customers application = the correct equipment for the application = increased productivity = decreased handling cost

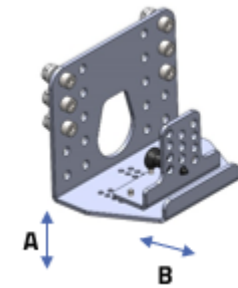

Art.no 12 26 41 00 Adjustable hook with latch

A. Min. – max height	B. Width beam	C. Height beam
90-210 mm	Max 52 mm	22-77 mm

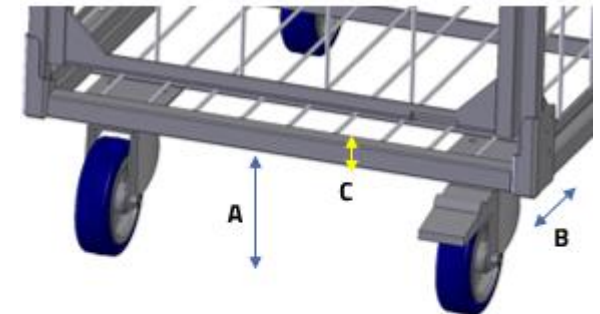

A – Height from floor to underside chassis  
B – Width chassi beam  
C – Height chassi beam





[TWE120]

## Electrical locking hook[12 26 40 90]

### Features

- This hook connect and locks the trolley to the tractor
- Locking and unlocking is handled by a button placed at handle
- Intended for use in application with inclination

### Benefit

- Ergonomic and quick handling
- This hook prevents the trolley from detaching from the tow device, which is idle when moving on a slope

Possibility to choose the tow device that suits the customers application = the correct equipment

for the application = increased productivity = decreased handling cost

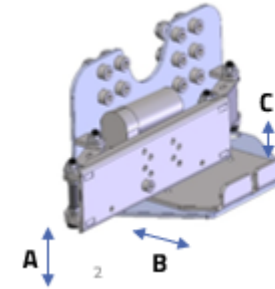

Art.no 12 26 40 90 Electrical hook

A. Min. – max height chassis	B. Width beam vagn	C. Height beam
97-215 mm	Max 52 mm	15-55 mm

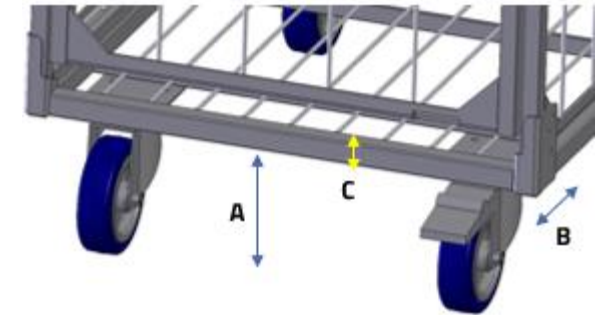

A – Height from floor to underside chassis  
B – Width chassi beam  
C – Height chassi beam



# Principle to connect a trailer to TWE200



TWE200

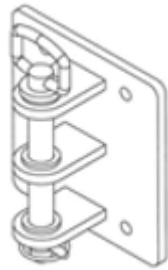

1

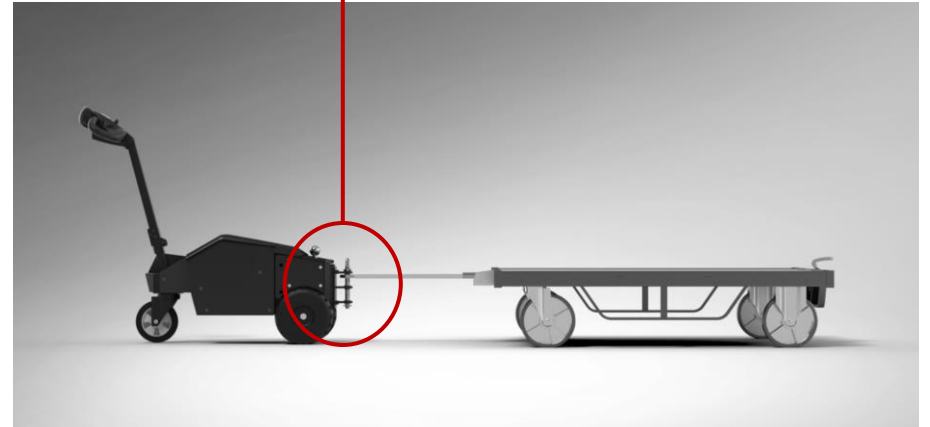

[TWE200]

- Mainly used with trailers equipped with a tow bar
- The trailers towbar is connected to either the towing pin device (1) or the tow ball (2)



2

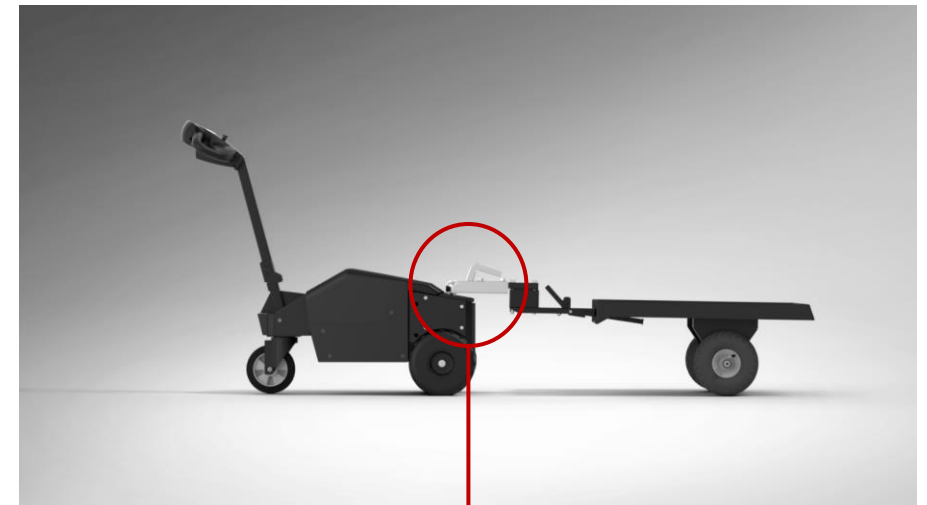
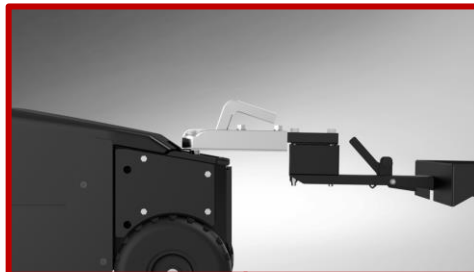

[TWE200]

## Standard towing device and tow ball [Included as standard in base model]

### Features

- Standard towing device (towing pin) and tow ball hook for model TWE200
- Available heights to connect to towing device are 205-325mm, pin is 22mm

### Benefits

- Towing device (towing pin) for towing of trolleys with attached towing bar
- Tow bar for towing of trailers with hitch

Possibility to choose the tow device that suits the customers application = the correct equipment for the application = increased productivity = decreased handling cost



[TWE200]

## Combination towing device/tow ball [07 07 04 30]

### Features

- This option is a combination of towing device and tow ball that is positioned in back of the tractor
- Towing device to pull trailers with drawbar and tow ball to pull trailers with hitch

### Benefit

- This option is useful if the trailers tow bar is equipped with a welded stand support (see picture). Standard solution will not work with a trailer with this support, it will not fit

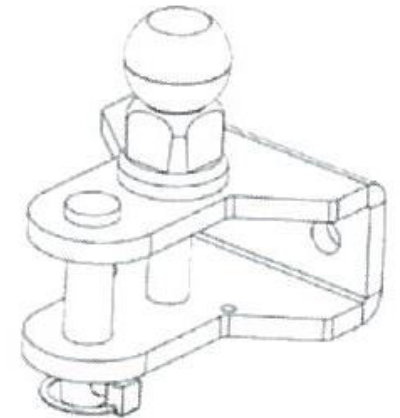

Possibility to choose the tow device that suits the customers application = the correct equipment for the application = increased productivity = decreased handling cost



## Coupling device waste bin [12 26 41 30]

[TWE200]

### Features

- This option is used to tow one or two waste bins with a TWE200
- The option is delivered with 4 locking devices that can be adjusted sideways to fit the waste bins that are used. When towing one small waste bin two locking devices are needed and when towing two small or one big waste bin four locking devices are needed
- The waste bins are automatically locked to the locking devices and are easily released by pushing the locking devices upwards
- It is very easy to switch between the standard towing device and the waste bin towing device
- This coupling device is fully compatible on older trucks
- This coupling device only fits together with the standard towing device for TWE200 and are not compatible together with the coupling device for shopping cart
- The height of the locking device is 764mm and total width is 600mm

### Benefit

- This option is very effective and ergonomic when handling waste bins
- Flexible when it is easy to use for both standard and waste bin coupling

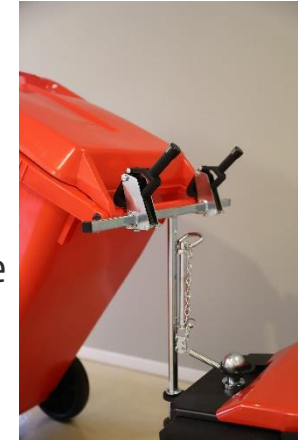

[TWE200]

## Coupling device shopping cart [12 94 16 23]

### Features

- Only available on TWE200
- Adjustable coupling for different types of shopping carts
- To be used with the remote-control [12 94 16 22]

### Benefit

- Enables a safe connection between the tractor and the shopping cart



Remote control and coupling device for shopping carts = aid for moving multiple shopping carts = Higher ergonomics & productivity



[TWE200]

## Remote Control [12 94 16 22]

### Features

- Remote control for TWE200
- Includes transmitter ,receiver and antenna.
- To be used with the coupling device shopping cart [12 94 16 23]

### Benefit

- This options enables an easy, ergonomic and safe aid when moving up to 25 shopping carts using the remote control. When ordering the remote an antenna is placed at the handle.



Remote control



Antenna



Remote control and coupling device for shopping carts = aid for moving multiple shopping carts = Higher ergonomics & productivity

PRODUCTIVITY

DRIVEABILITY

SAFETY

DURABILITY



**[TWE200]**

### Extra weight package [12 26 41 15]

#### Features

- Only available on TWE200
- The extra weight package can be an option when extra drive wheel pressure is needed, for example if the floor is slippery or if the customer are working in slopes
- The weight of the package is 28 kg and the width is 550 mm
- The extra weight package is fully compatible on older trucks

#### Benefit

- To be used if more drive wheel pressure is needed





[TWE120/TWE200]

## Keypad [12 26 41 10, TWE120] [12 26 41 11, TWE200]

### Features

- Keypad with up to 20 different pin codes
- Key still needed to activate the tractor, keypad to be seen as additional authorization

### Benefit

- This facilitates higher safety in public areas and ensures no unauthorized usage



Safe access to tractor = correct driver = less accidents = decreased handling cost



[TWE120/TWE200]

## Hour counter [12 94 23 43]

### Features

- An hour counter that displays how many hours the machine has been running
- The counted time is when the machine is driven forward or backward (b-hours)

### Benefit

- Easy to see how many hours the machine has been used
- Beneficial when working with rental contracts



[TWE120]

## Battery table [14 17 40 20]

### Features

- Battery table on wheels for TWE120
- There are two positions at the table for two batteries. The charger can be installed on the table. The charger is ordered separately

### Benefit

- The battery table enables an ergonomic, quick and easy battery replacement

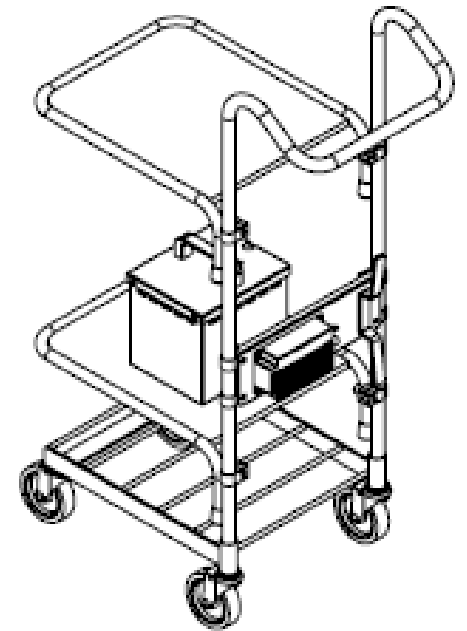

Battery change = customers can use battery change instead of investing in a extra tractor and by that you get more hours with the same tractor = increase productivity = decreased handling cost

PRODUCTIVITY

DRIVEABILITY

SAFETY

DURABILITY

[TWE120]

## Battery set, AGM, 2 x 12V/22Ah [12 26 40 80]

### Features

- Available on TWE120
- AGM batteries comes in set of two batteries together in a box
- Weight is under 13 kg which gives an easy and ergonomic battery change if needed

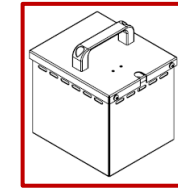

### Benefit

- Possibility to adapt the correct type of battery to the customers need and application

Different batteries = more adapted equipment that supports the customers needs = increase productivity = decreased handling cost



[TWE200]

## Battery set, AGM, 2 x 12V/36Ah [12 26 40 81]

### Features

- Available on TWE200
- AGM batteries in set of two
- No battery change as option due to that other battery options available like GEL



### Benefit

- Possibility to adapt the correct type of battery to the customers need and application

Different batteries = more adapted equipment that supports the customers needs = increase productivity = decreased handling cost



**[TWE200]**

## Battery set, GEL , 2 x 12V/76Ah [12 26 40 82]

### Features

- Available on TWE200
- Set of GEL batteries
- No battery change as option due to that other battery options available like Li-ion

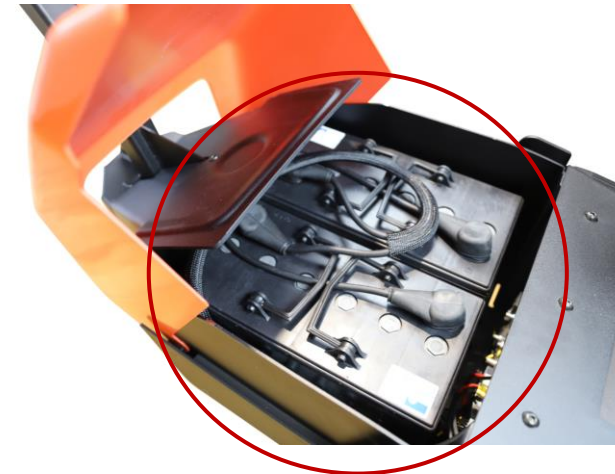

### Benefit

- Possibility to adapt the correct type of battery to the customers need and application

Different batteries = more adapted equipment that supports the customers needs = increase productivity = decreased handling cost



[TWE120]

## Battery set, Lithium, 1 x 24V/48Ah [12 26 11 64]

### Features

- Available on TWE120
- 24V / 48Ah
- Lithium battery for more intensive application and multiple shifts
- Battery status display that shows the remaining battery power
  - One short click starts the battery
  - Two long clicks turns off the battery

### Benefit

- Possibility to adapt the correct type of battery to the customers need and application

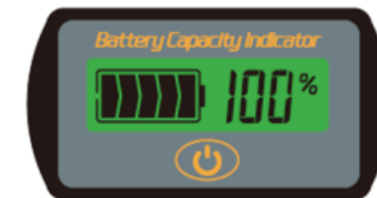

Different batteries = more adapted equipment that supports the customers needs = increase productivity = decreased handling cost



[TWE200]

## Battery set, Lithium, 1 x 24V/48Ah [12 26 11 63]

### Features

- Available on TWE200
- 24V / 48Ah
- Lithium battery for more intensive application and multiple shifts
- Battery status display that shows the remaining battery power
- Push button on the truck
  - One short click starts the battery
  - Two long clicks turns off the battery

### Benefit

- Possibility to adapt the correct type of battery to the customers need and application

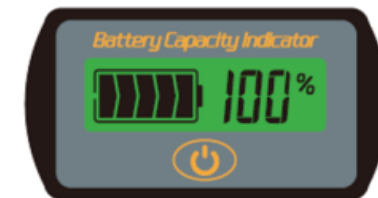

Different batteries = more adapted equipment that supports the customers needs = increase productivity = decreased handling cost





[TWE200]

## Battery set, Lithium, 1 x 24V/96Ah [12 26 11 62]

### Features

- Available on TWE200
- 24V / 96Ah (2 x 48Ah batteries)
- Lithium battery for more intensive application and multiple shifts
- Battery status display that shows the remaining battery power
- Push button on the truck
  - One short click starts the battery
  - Two long clicks turns off the battery



### Benefit

- Possibility to adapt the correct type of battery to the customers need and application

Different batteries = more adapted equipment that supports the customers needs = increase productivity = decreased handling cost



[TWE120/TWE200]

## Charger, 24V/4A (For AGM batteries) [12 26 40 85]

### Features

- Charger for AGM batteries
- 24V/4 A

### Benefit

- Correct type of charger for correct charging of different type of batteries

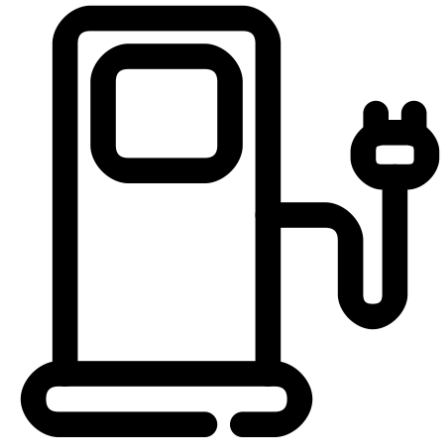

Different chargers and batteries = more adapted equipment that supports the customers needs = increase productivity = decreased handling cost



[TWE200]

## Charger, 24V/16,5A (For GEL batteries) [12 26 40 86]

### Features

- Available on TWE200
- Charger for AGM batteries
- 24V/16,5A

### Benefit

- Correct type of charger for correct charging of different type of batteries

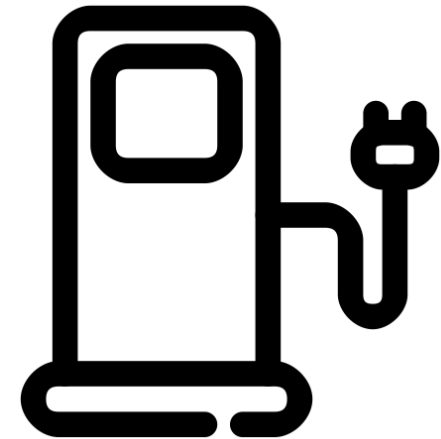

Different chargers and batteries = more adapted equipment that supports the customers needs = increase productivity = decreased handling cost



[TWE120/TWE200]

## Li-ion charger 24V/40A (For Lithium batteries) [12 26 11 43]

### Features

- Charger for Lithium batteries
- 24V/40A
- For TWE200 and TWE120 with 48Ah batteries

### Benefit

- Correct type of charger for correct charging of different type of batteries

Different chargers and batteries = more adapted equipment that supports the customers needs = increase productivity = decreased handling cost



PRODUCTIVITY

DRIVEABILITY

SAFETY

DURABILITY

[TWE200]

## Li-ion charger 24V/80A (For Lithium batteries) [12 26 11 44]

### Features

- Charger for Lithium batteries
- 24V/80A
- For TWE200 with 96Ah batteries

### Benefit

- Correct type of charger for correct charging of different type of batteries



Different chargers and batteries = more adapted equipment that supports the customers needs = increase productivity = decreased handling cost

